

NE14

NW13 9-25-4

0510785

NE13

1'

9812087

2 ST N

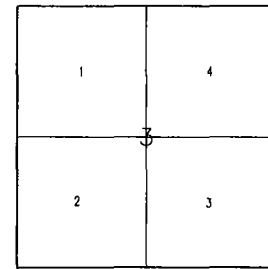
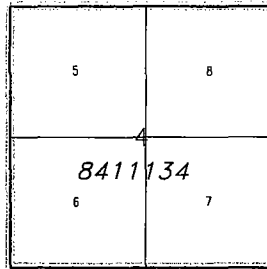
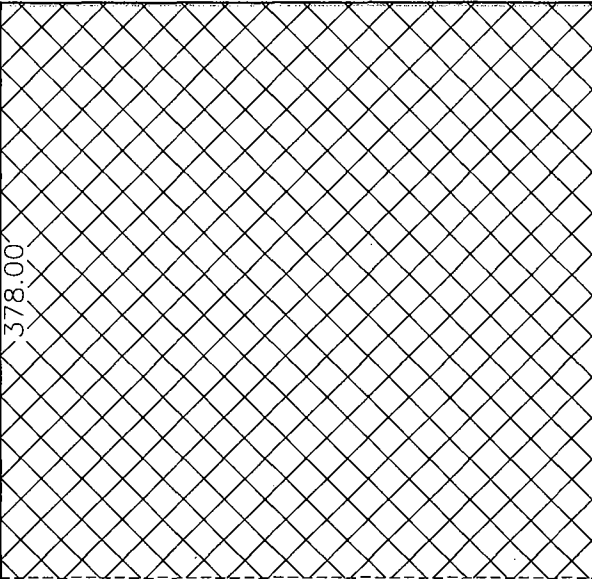

1 ST N

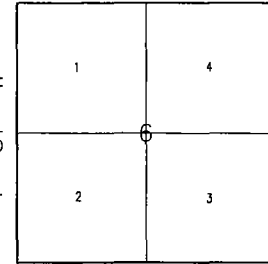
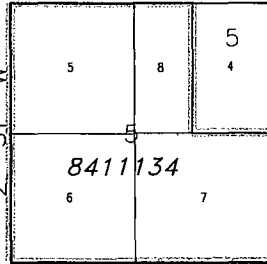

1 ST W

MAIN ST

SW13 9-25-4

CENTRE ST

3691DI

8510518

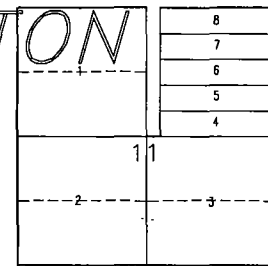
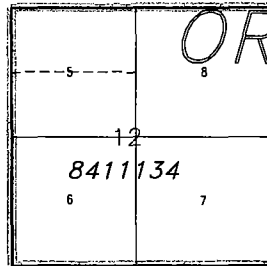

ORTON

1 ST S

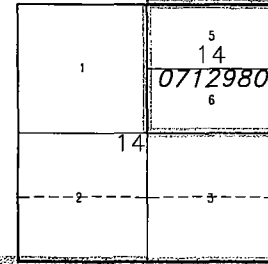
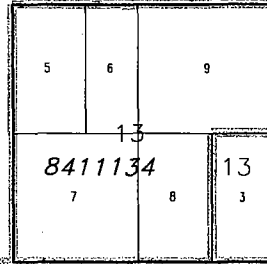

SE14 9-25-4

SE13 9-25-4

NE11

NW12 9-25-4

NE12

LAND USE DISTRICT REDESIGNATION SCHEDULE 'A'



FROM: RURAL GENERAL (RG)

TO: GROUPED COUNTRY RESIDENTIAL (GCR)

LSD 5 IN SW 1/4 SEC 13, TWP 9, RGE 25, W 4 M
MUNICIPALITY; M. D. OF WILLOW CREEK NO. 26
DATE; JULY 10, 2007



OLDMAN RIVER REGIONAL SERVICES COMMISSION

0 Metres 100 200 300 400

July 10, 2007 N:\Willow-Creek-MD\Willow-Creek- Land Use Redesignations\WCreek SW 13-9-25-4.dwg



MAP PREPARED BY:
OLDMAN RIVER REGIONAL SERVICES COMMISSION
3105 16th AVENUE NORTH, LETHBRIDGE, ALBERTA -
TEL. 329-1344 T1H 5E8
"NOT RESPONSIBLE FOR ERRORS OR OMISSIONS"